

# CITY OF SEBASTOPOL

## ZONING MAP

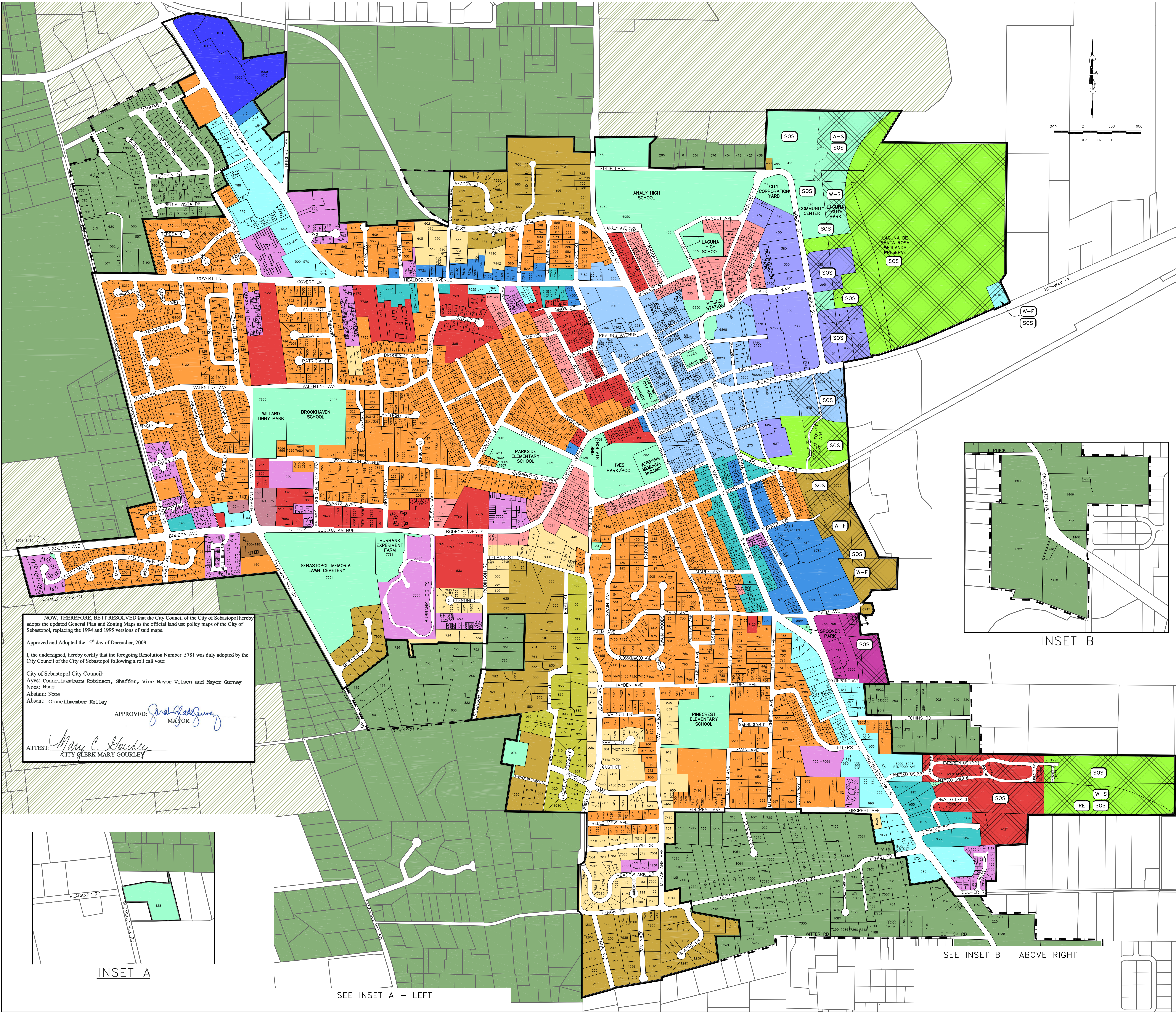
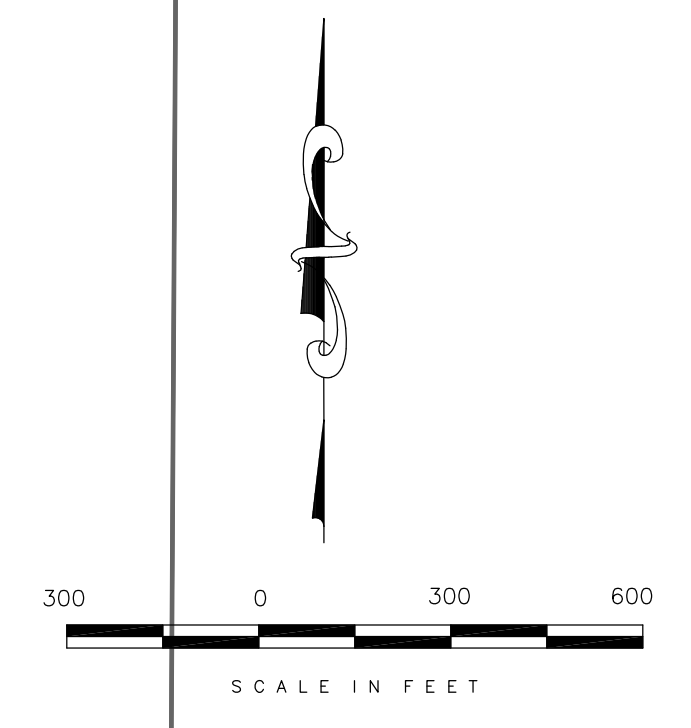

**SEBASTOPOL ZONING DISTRICTS**

**RESIDENTIAL DISTRICTS**

- RA RESIDENTIAL AGRICULTURAL
- RR RURAL RESIDENTIAL
- RSF-1 LOW DENSITY SINGLE FAMILY
- RSF-2 MEDIUM DENSITY SINGLE FAMILY
- RD DUPLEX RESIDENTIAL
- RM-M MEDIUM DENSITY MULTIPLE FAMILY
- RM-H HIGH DENSITY MULTIPLE FAMILY

**COMMERCIAL DISTRICTS**

- O OFFICE
- CO NEIGHBORHOOD COMMERCIAL
- CN OFFICE COMMERCIAL
- CG GENERAL COMMERCIAL
- CD DOWNTOWN CORE
- CH HEAVY COMMERCIAL

**INDUSTRIAL DISTRICTS**

- M INDUSTRIAL
- O/LI OFFICE/LIGHT INDUSTRIAL

**SPECIAL DISTRICTS**

- CF COMMUNITY FACILITIES
- PC PLANNED COMMUNITY
- W PRIMARY WETLANDS DISTRICT
- SOS SCENIC OPEN SPACE COMBINING
- W-F WETLANDS FRINGE COMBINING DISTRICT
- W-S SECONDARY WETLANDS COMBINING DISTRICT
- RE RESIDENTIAL ESTATE

**SONOMA COUNTY ZONING DISTRICTS**

- RR RURAL RESIDENTIAL
- DA DIVERSE AGRICULTURAL



INSET B

NOW, THEREFORE, BE IT RESOLVED that the City Council of the City of Sebastopol hereby adopts the updated General Plan and Zoning Maps as the official land use policy maps of the City of Sebastopol, replacing the 1994 and 1995 versions of said maps.

Approved and Adopted the 15<sup>th</sup> day of December, 2009.

I, the undersigned, hereby certify that the foregoing Resolution Number 5781 was duly adopted by the City Council of the City of Sebastopol following a roll call vote:

City of Sebastopol City Council:  
 Ayes: Councilmembers Robinson, Shaffer, Vice Mayor Wilson and Mayor Gurney  
 Noes: None  
 Abstain: None  
 Absent: Councilmember Kelley

APPROVED: *John G. Gurney*  
 MAYOR

ATTEST: *Mary C. Gourley*  
 CITY CLERK MARY GOURLEY

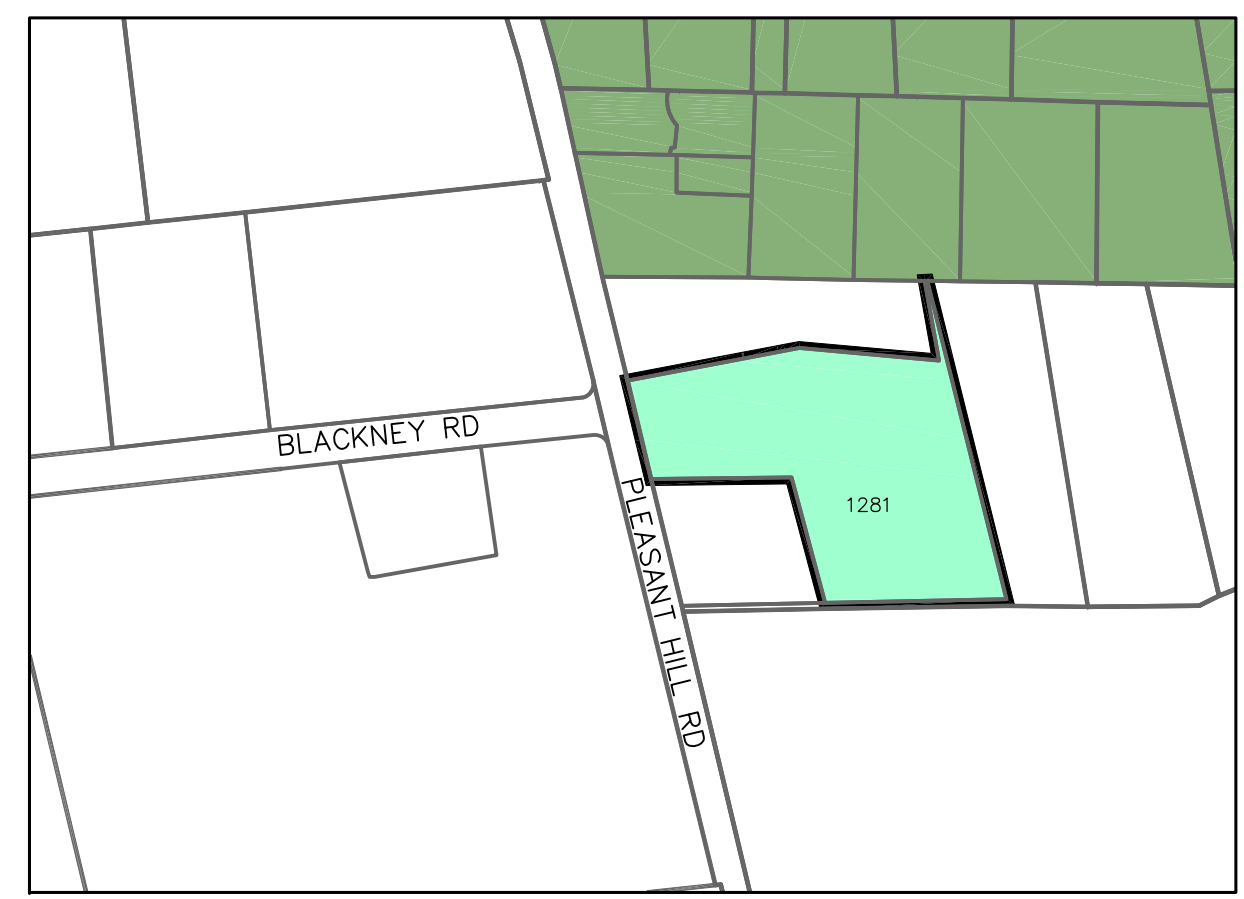

INSET A

SEE INSET A - LEFT

SEE INSET B - ABOVE RIGHT

**MAP NOTES:**

1. PARCEL LINES SHOWN ARE FROM COUNTY OF SONOMA GIS DEPARTMENT PARCEL SHAPE FILE. THESE HAVE BEEN DIGITIZED FROM SONOMA COUNTY ASSESSOR PARCEL MAPS AND ARE FOR REPRESENTATION PURPOSES ONLY.
2. THIS MAP REFLECTS ZONING DESIGNATIONS ADOPTED BY THE SEBASTOPOL CITY COUNCIL AS OF DECEMBER 15, 2009.
3. COUNTY OF SONOMA ZONING DISTRICTS SHOWN ARE BASED ON "LAND USE PLAN MAP, SEBASTOPOL AND ENVIRONS", ADOPTED MARCH 23, 1989. THESE ZONING DISTRICTS ARE SHOWN FOR REPRESENTATION PURPOSES ONLY.